

# Structural Profiles



**Pultrac** composite structural profiles are an Easy, Safe and Simple alternative to steel, aluminum and wooden structural components. The profiles are manufactured using vinyl ester resin, providing superior quality over polyester resins, offering enhanced chemical resistance. Unidirectional fibres and multidirectional mats are combined to provide the structural profile with the optimum mechanical properties. The combination of the resins and fibres give the profiles greater strength and low thermal conductivity values.

The high strength to weight ratio means **Pultrac** structural profiles are **Easy** to transport, lightweight and **Safe** to handle, and **Simple** to cut and install.

Each composite structural shape is available in a number of dimensions and colours suitable for a variety of designs and application requirements. Custom shapes are also available upon request.

## Universal Beam

Stock code	Dimension (mm)	Weight (kg/m)
	AxBxCxD	
PUB76A	76x152x6.4x6.4	3.59
PUB76B	76x152x9.5x9.5	5.32
PUB102A	102x203x9.5x9.5	7.20
PUB102B	102x203x12.7x12.7	9.50
PUB127A	127x254x9.5x9.5	9.00
PUB127B	127x254x12.7x12.7	11.90
PUB152A	152x305x9.5x9.5	10.74
PUB152B	152x305x12.7x12.7	14.30



# Structural Profiles

## Universal Column

Stock code	Dimension (mm)	Weight (kg/m)
	AxBxCxD	
PUC76	76x76x6.4x6.4	2.67
PUC102A	102x102x6.4x6.4	3.59
PUC102B	102x102x8.0x8.0	4.50
PUC152A	152x152x6.4x6.4	5.43
PUC152B	152x152x9.5x9.5	8.10
PUC203A	203x203x9.5x9.5	10.8
PUC203B	203x203x12.7x12.7	14.36
PUC203C	203x203x6.4x6.4	7.50
PUC254A	254x254x9.5x9.5	13.60
PUC254B	254x254x12.7x12.7	18.04
PUC305	305x305x12.7x12.7	21.50

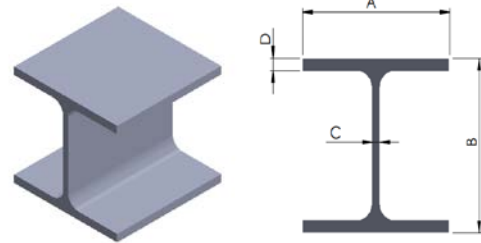

## Channel

Stock code	Dimension (mm)	Weight (kg/m)
	AxBxCxD	
PC76A	76x25x4.8x4.8	1.06
PC76B	76x38x6.4x6.4	1.70
PC90	90x35x8.0x8.0	2.10
PC102	102x44x6.4x6.4	2.10
PC120	120x50x5.0x5.0	2.00
PC152A	152x42x9.5x9.5	3.95
PC152B	152x50x8.0x8.0	3.59
PC203	203x56x9.5x9.5	5.34
PC210	210x85x5.0x5.0	3.52
PC254	254x70x12.7x12.7	8.90
PC292	292x70x12.7x12.7	9.60

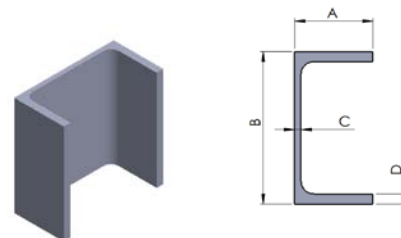

## Rectangular Hollow Section

Stock code	Dimension (mm)	Weight (kg/m)
	AxBxC	
PRHS50A	50x25x3x3	0.79
PRHS50B	50x25x6.4x6.4	1.54
PRHS51A	51x25x4x4	1.01
PRHS51B	51x38x4x4	1.22
PRHS52	52x32x5x5	1.41
PRHS91A	91x38x4x4	1.78
PRHS91B	91x112x6.4x6.4	4.46

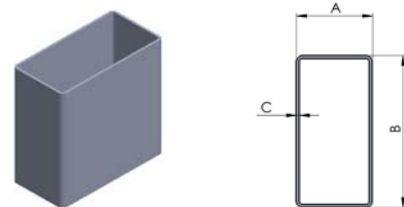

# Structural Profiles

## Square Tube

Stock code	Dimension (mm)	Weight (kg/m)
	AxBxC	
PS50C	50x50x4.0x4.0	1.42
PS50D	50x50x5.0x5.0	1.74
PS50E	50x50x6.4x6.4	2.12
PS54A	54x54x3.2x3.2	1.24
PS54B	54x54x4.8x4.8	1.78
PS64A	64x64x3.2x3.2	1.48
PS64B	64x64x4.4x4.4	1.97
PS64C	64x64x6.4x6.4	2.80
PS76A	76x76x3.2x3.2	1.77
PS76B	76x76x5.0x5.0	2.70
PS76C	76x76x6.4x6.4	3.39
PS101A	101x101x3.2x3.2	2.38
PS101B	101x101x5.0x5.0	3.61
PS101C	101x101x6.4x6.4	4.61
PS152A	152x152x6.4x6.4	7.10
PS152B	152x152x9.5x9.5	10.4
PS152C	152x152x12.7x12.7	13.5

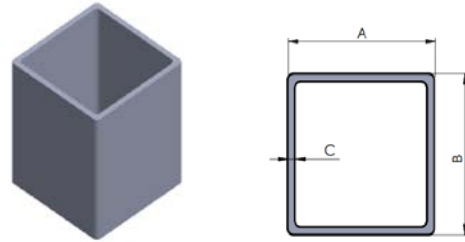

## Kick Plate

Stock code	Dimension (mm)	Weight (kg/m)
	AXBXC	
M-shape		
PKM3	100x16x5.0	1.30
PKM4	148x12x3.0	1.27
W-shape		
PKW1	100x19x5.0	1.36
PKW2	100x14x3.2	1.10

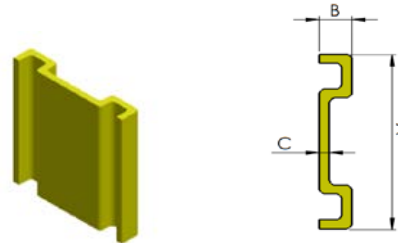

## Round Tube

Stock code	Dimension (mm)	Weight (kg/m)
	AxB	
PR50C	50X5.0	1.34
PR50D	50X6.4	1.67
PR50E	50X3.5	0.96
PR64A	64X3.5	1.26
PR64B	64X7.0	2.38
PR76	76X6.4	2.64

